







LEGEND

- |   |                    |   |                        |
|---|--------------------|---|------------------------|
| ●   | FOUND 1" IRON PIPE |  | EXISTING CONCRETE      |
|  | CONCRETE MONUMENT  |  | EXISTING ASPHALT DRIVE |
| —+—   | WOODEN FENCE       |  | EXISTING BUILDING      |
| □   | PILLAR             |  | EXISTING DECK          |
|  | POWER POLE         |   |                        |
|  | UTILITY PEDESTAL   |   |                        |
| ( XX )  | RECORDED AS        |   |                        |

# PLAT OF SURVEY

A PARCEL OF LAND LOCATED IN THE SOUTHWEST 1/4 OF THE NORTHEAST 1/4 OF SECTION 6 IN TOWNSHIP 1 NORTH, RANGE 17 EAST, IN THE VILLAGE OF WILLIAMS BAY, WALWORTH COUNTY, WISCONSIN

LOT 102  
CEDAR POINT PARK

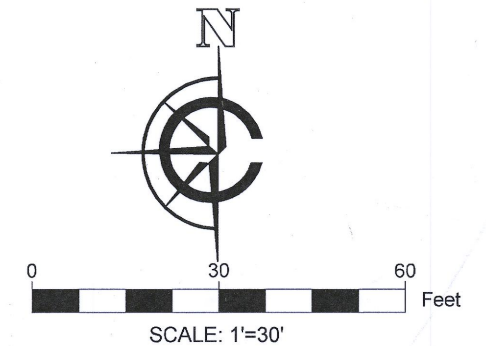
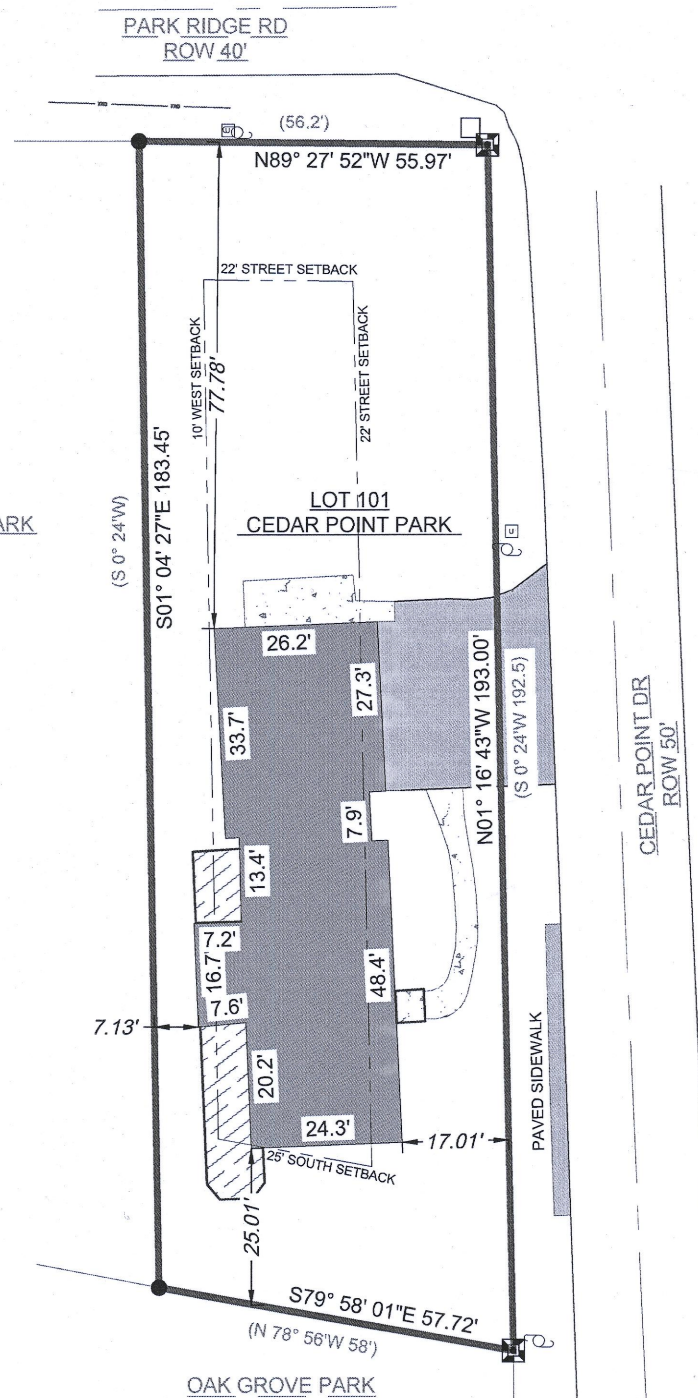

NOTE:

1. BASIS OF BEARING: THE WISCONSIN STATE PLANE COORDINATE SYSTEM, NAD-83, SOUTH ZONE.
2. FIELD WORK COMPLETED MARCH 23, 2020
3. BUILDING SURVEYED TO THE EXTERIOR OF SIDING.
4. SETBACKS PROVIDED BY WILLIAMS BAY ZONING ADMINISTRATOR.

LEGAL DESCRIPTION:

A PARCEL OF LAND LOCATED IN THE SOUTHWEST 1/4 OF THE NORTHEAST 1/4 OF SECTION 6 IN TOWNSHIP 1 NORTH, RANGE 17 EAST, IN THE VILLAGE OF WILLIAMS BAY, WALWORTH COUNTY, WISCONSIN, MORE PARTICULARLY DESCRIBED AS:

LOT 101 CEDAR POINT PARK 2ND ADD. VILLAGE OF WILLIAMS BAY AS RECORDED IN THE DOCUMENT #P252577 IN THE WALWORTH COUNTY REGISTER OF DEEDS

SURVEY ORDERED BY:

EGERT LAW, S.C.  
835 GENEVA PARKWAY NORTH, SUITE 1  
LAKE GENEVA, WI 53147

PROPERTY ADDRESS:

14 CEDAR POINT DR  
WILLIAMS BAY, WI 53191

SURVEYOR:

PAUL H. VAN HENKELUM, PLS  
CARDINAL ENGINEERING LLC

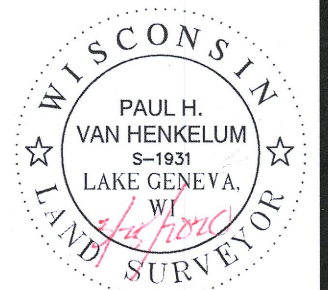

"I HEREBY CERTIFY THAT I HAVE SURVEYED THE ABOVE DESCRIBED PROPERTY AND THE MAP IS A TRUE AND CORRECT REPRESENTATION OF ITS EXTERIOR BOUNDARIES AND SHOWS THE SIZE AND LOCATION OF ALL VISIBLE STRUCTURES, APPARENT EASEMENTS AND ENCROACHMENTS, IF ANY."

*Paul H. Van Henkelum*  
PAUL H VAN HENKELUM, PLS #1931

*3/25/2020*  
DATE



CARDINAL ENGINEERING LLC  
DESIGNING IN TRUE DIRECTIONS

PO BOX 281 - 1200 LASALLE ST.  
LAKE GENEVA, WI 53147  
262-757-8776  
CARDINALENGINEERINGWI.COM

DATE: 03/25/2020 JOB No. 20325  
SHEET 1 OF 1

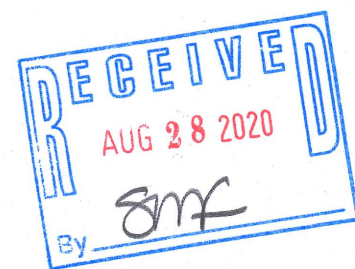

WCP2-1

011-29167